

Specifications

Current Rating: 0.5A~1A AC,DC(Per Pin)

Voltage Rating: 200V AC,DC(Per Pin)

Temperature Range: -25°C ~ +85°C

Contact Resistance: 40mΩ Max.

Insulation Resistance: 100MΩ Min.

Withstanding Voltage: 500V AC/minute

A

B

C

F

Standards

Assembly Layout

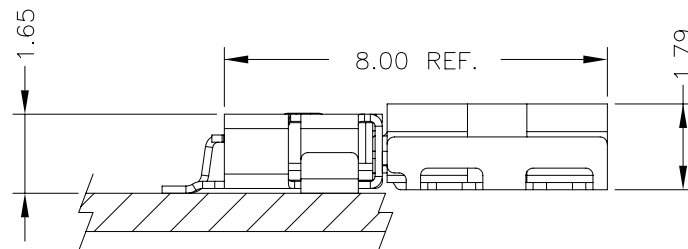

Ordering Code

① ② ③ ④
A1001 - X X X

- ① Series No.
- ② Plating Code: G=Gold-Plated
- ③ Material: P=Phosphor Bronze
- ④ E=Stamping Before Plating

① ② ③
A1001 X - XP

- ① Series No.
- ② Housing Type: H=Housing
- ③ No. of Circuits

① ② ③ ④
A1001 XX - X - XP

- ① Series No.
- ② Connector Type: WR=Right Angle
- ③ Mounting Type: S=SMT
- ④ No. of Circuits



A1001 SERIES

1.00mm Pitch Wire to Board Connector

A1001-XXX

1.00mm Pitch Crimp Terminal

Reference Information:

*Used in A1001 Series Housing

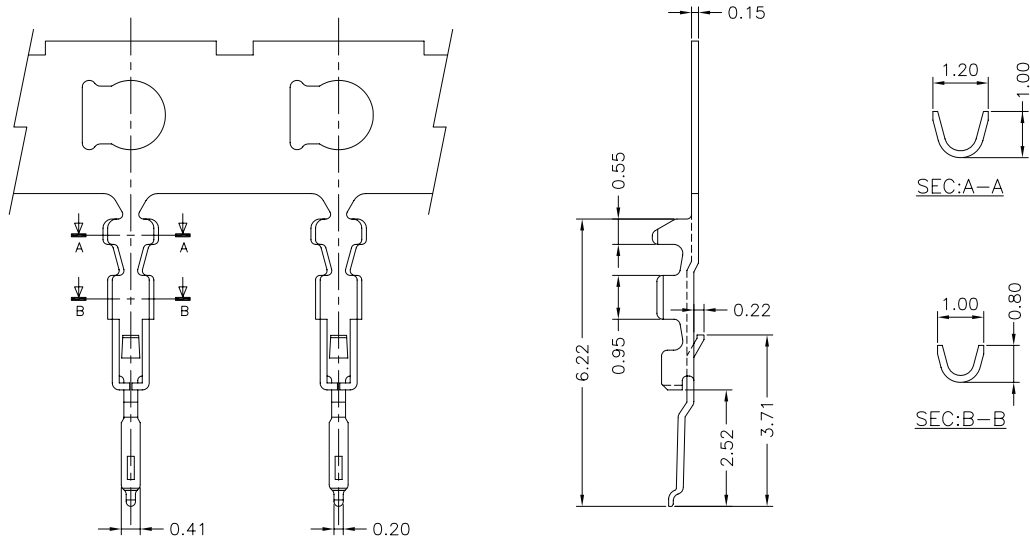

Ordering Information & Specifications:

Unit:mm

Part No.	Wire Range	Insulation O.D.	Material	Finish	Qty/Reel
A1001-GPE-A	AWG#28-#36	0.50mm(Max)	Phosphor Bronze	Gold-Plated	20,000Pcs
A1001-GPE-A2	AWG#28-#36	0.50mm(Max)	Phosphor Bronze	Gold-Plated 30u"	20,000Pcs

Note:E-Stamping Before Plating

A1001H

1.00mm Pitch Housing

Reference Information:

*Material: Housing: Thermoplastic

Shell: Copper Alloy

*Suitable A1001 Series Terminal

*Mates with A1001 Series Wafer

A1001H-XP	X	X	X	XX	X	XX	X
	①	②	③	④	⑤	⑥	⑦
①	Halogen Free or Not						
②	Material						
③	Color						
④	Plating Code for Contacts						
⑤	Plating Code						
⑥	Option Code						
⑦	Packing Code						

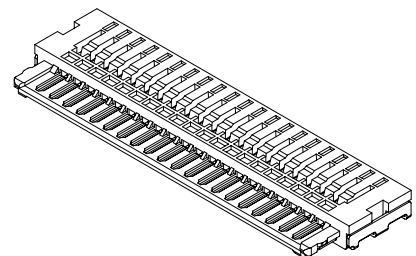
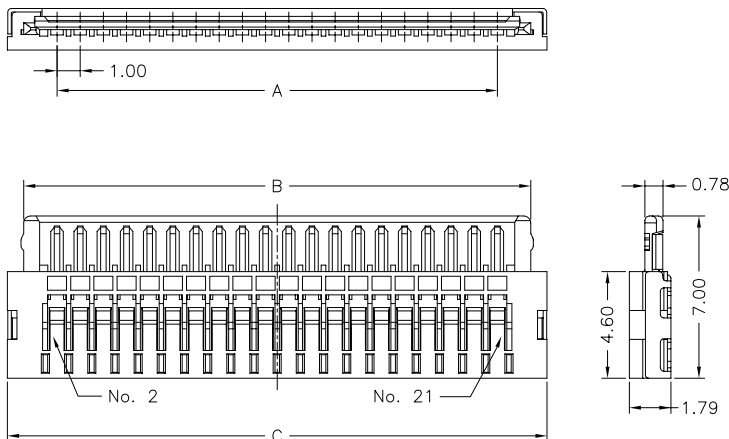

Dimensions:

Circuit No.	Dimensions		
	A	B	C
20	19.00	21.88	23.28
30	29.00	31.88	33.28

Unit:mm



A1001 SERIES

1.00mm Pitch Wire to Board Connector

A1001WR-S

1.00mm Pitch 90° Wafer - SMT Type

Reference Information:

- *Material: Pin: Copper Alloy
Shell: Copper Alloy
Wafer: Thermoplastic
- *Mates with A1001 Series Housing

A1001WR-S-XP	X	X	X	XX	X	XX	X
	①	②	③	④	⑤	⑥	⑦
①	Halogen Free or Not						
②	Material						
③	Color						
④	Plating Code for Contacts						
⑤	Plating Code						
⑥	Option Code						
⑦	Packing Code						

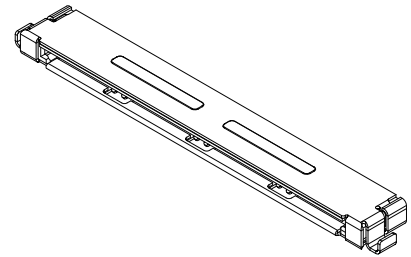

Dimensions:

Circuit No.	Dimensions		
	A	B	C
20	19.00	21.00	26.65
30	29.00	31.00	36.65

Unit:mm

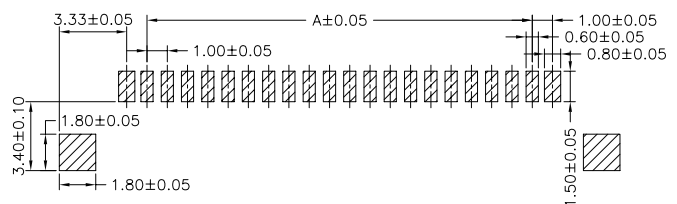
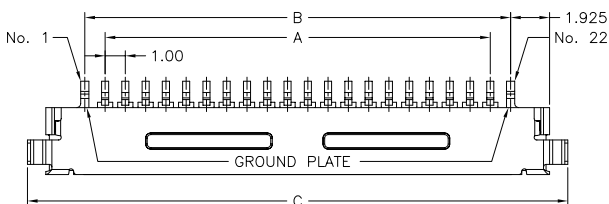

PCB Layout

