

Specifications

Current Rating: 1A AC,DC(Per Pin)

Voltage Rating: 200V AC,DC(Per Pin)

Temperature Range: -25°C ~ +85°C

Contact Resistance: 20mΩ Max.

Insulation Resistance: 1000MΩ Min.

Withstanding Voltage: 900V AC/minute

A

B

C

F

Ordering Code

① A1258 ② X ③ X- ④ XP

① Series No.

② Housing Type: H=Housing

③ A=A Type, B=B Type

④ No. of Circuits



A1258 SERIES

1.25mm Pitch Wire to Board Connector

A1258HA

1.25mm Pitch Housing

Reference Information:

*Material: Thermoplastic

*Suitable A1255 Series Terminal

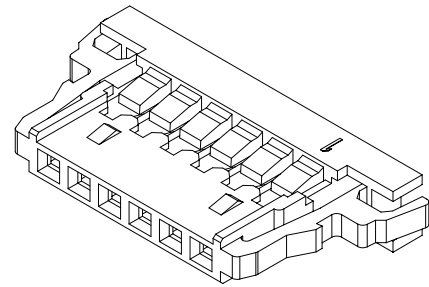
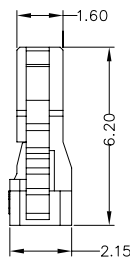
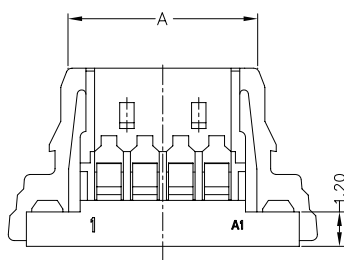
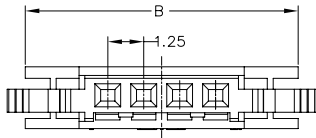

A1258HA-XP X X X XX X XX X
① ② ③ ④ ⑤ ⑥ ⑦

- ① Halogen Free or Not
- ② Material
- ③ Color
- ④ Plating Code for Contacts
- ⑤ Plating Code
- ⑥ Option Code
- ⑦ Packing Code

Dimensions:

Circuit No.	Dimensions	
	A	B
03	5.35	8.25
04	6.60	9.50
06	9.10	12.00

Unit:mm

A1258HB-06P

1.25mm Pitch Housing

Reference Information:

*Material: Thermoplastic

*Suitable A1255 Series Terminal

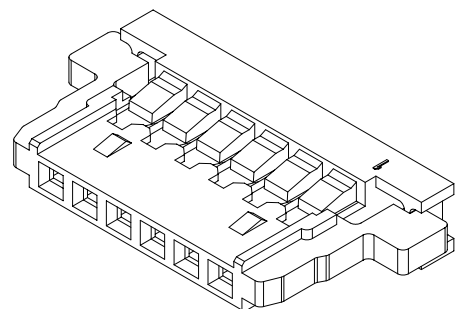
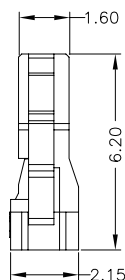
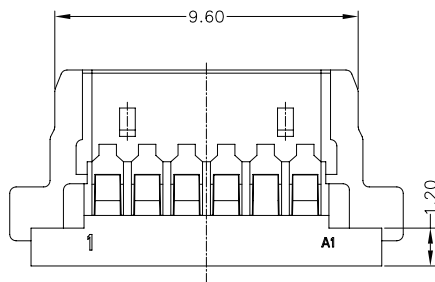
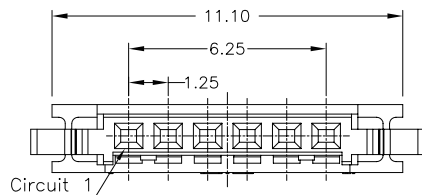

A1258HB-XP X X X XX X XX X
① ② ③ ④ ⑤ ⑥ ⑦

- ① Halogen Free or Not
- ② Material
- ③ Color
- ④ Plating Code for Contacts
- ⑤ Plating Code
- ⑥ Option Code
- ⑦ Packing Code